

Patio

Breakfast Area
10'3" x 11'0"
9'0" Ceiling

Great Room
14'1" x 16'6"
9'0" Ceiling

Kitchen
10'3" x 10'6"
9'0" Ceiling

Pan.

Ref.

Arch

Arch

Living Room
13'11" x 13'5"
9'0" Ceiling

Up

Bath

Arch

Foyer

Covered
Entry

Arch

2-Car Garage
19'0" x 19'6"

First Floor

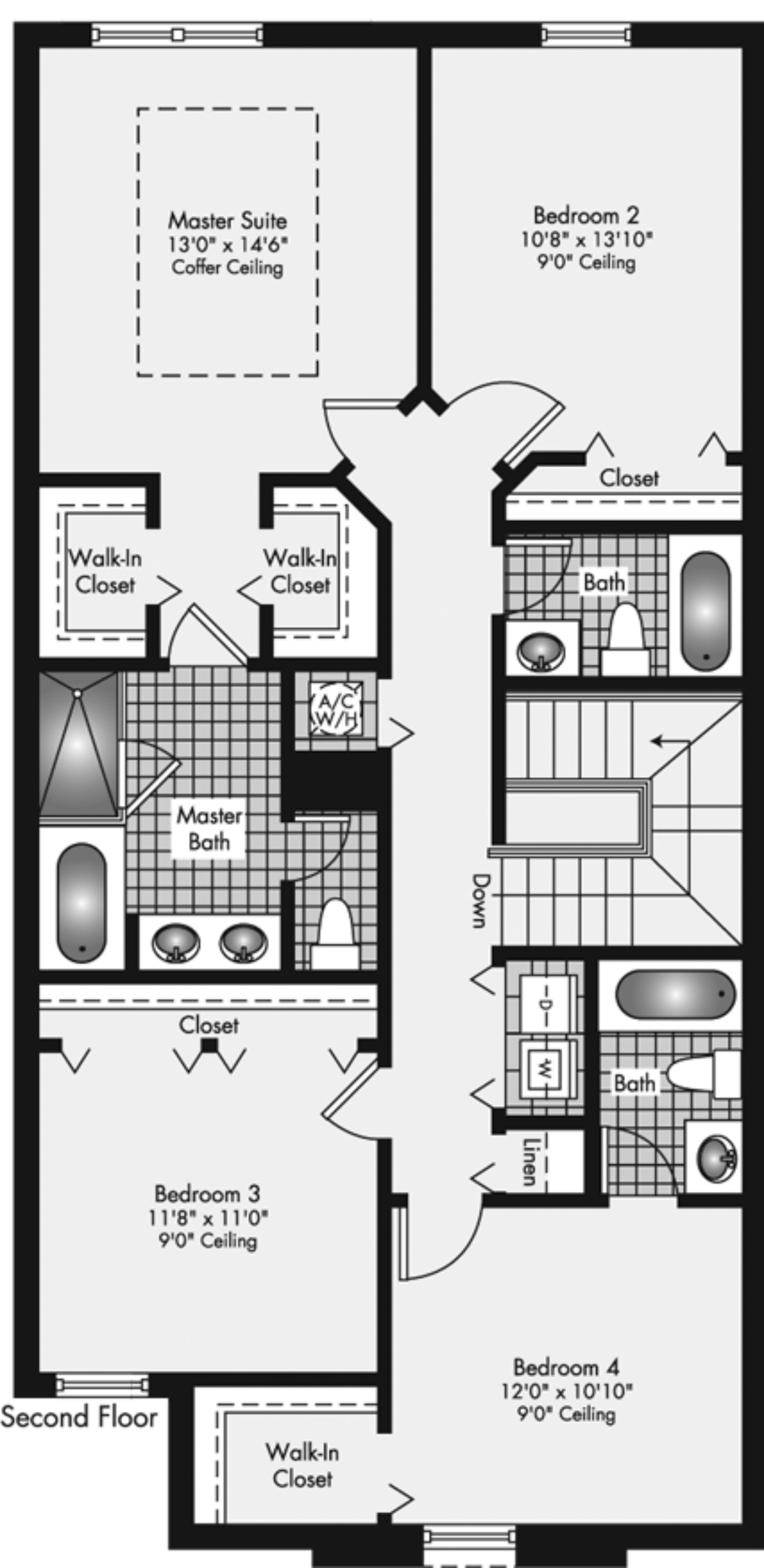

Master Suite
13'0" x 14'6"
Coffer Ceiling

Bedroom 2
10'8" x 13'10"
9'0" Ceiling

Walk-In
Closet

Walk-In
Closet

Closet

Bath

Master
Bath

A/C
W/H

Down

Closet

Bath

Bedroom 3
11'8" x 11'0"
9'0" Ceiling

Bedroom 4
12'0" x 10'10"
9'0" Ceiling

Walk-In
Closet

Second Floor